

LOGIN, LOGOUT

Login

Confirm that the terminal unit is idle then do the following:

1. Confirm that [SYNC (NCS)] appears at the bottom of the screen.
2. Press the **F7** key to display the [Options] menu.

Options	
1. Position	
2. Login	
3. Logout	
4. Abort	
5. Select NCS	
6. Ocean Region	
7. LES Information	
8. Test	
9. Maintenance	

3. Press the **2** key to display the [Login] screen.

Login	
Start	

Yes No	

4. [Yes] is selected in the [Start] window; press the **Enter** key to start the login process.

When login is completed, the message "Successful Login" appears. Press the **Esc** key to go to the standby display.

Logout

1. Press the **F7** and **3** keys to display the [Logout] screen.
2. [Yes] is selected in the [Start] window; press the **Enter** key to start the logout process.

When logout is completed, the message "Successful Logout." appears and the [Current State] indication changes from [LOGOUT] to [IDLE]. Then, turn off the FELCOM.

HOW TO SEND A MESSAGE TO A STATION SAVED TO THE STATION LIST

1. Prepare message on the screen.
For e-mail, set [Text Mode] in the [Editor Setup] menu to [Ascii].
2. Press the **F3** key to display the [Transmit] menu.

Transmit	
1. Transmit Message	
2. Cancel	
3. Request Delivery Status	

3. Press the **1** key to display the [Transmit Message] menu.

Transmit Message			
Priority	Normal		
Message File		Size	24
Station Name			
Destination Type	TELEX/MES		
Prefix Code			
Country/Ocean Code	82		
Destination	65-2111		
Modem Type			
Address			
Subject			
Attach File			
LES ID	303 (KDDI)		
Option	ON		
Confirmation	00:00		
Send Delay	Immediate		
Delivery Delay	IA5		
Code			
[TRANSMIT]			

4. Select [Station Name] then press the **Enter** key to open the Station List.

Station List			
Group	Station Name	Type	Code ID / Address
01	FURUNO	TELEX/ 81	321
02	FRNINMBTSTS	TELEX/	583 343199999
03	Seagull	E-Mail	Seagull@furuno.co.jp
04	whale	E-Mail	whale@furuno.co.jp
05			
06			
07			
08			

↑ ↓: Select SPACE: Select Stations B.SPACE: Cancel Mark INS: Edit Sort (Ctrl+G: Group, Ctrl+N: Station Name, Ctrl+T: Type)

5. Choose a station then press the **Enter** key. To select multiple stations (simultaneous transmission), select a station and then press the Spacebar.
6. For e-mail do the following. For other types, go to step 7.
 - 1) Select [Subject] then press the **Enter** key.
 - 2) Type subject then press the **Enter** key.
 - 3) To attach a file, select [Attach File] then press the **Enter** key.
 - 4) Press the **Enter** key to open the file list.
 - 5) Select a file then press the **Enter** key.
 - 6) Press the **Esc** key to close the window. Go to step 7.
7. Select [LES ID] then press the **Enter** key to open the LES setting window.

Name	LES ID	Remarks
Vizada 201	201	USA
Stratos Global	202	CANADA
KDDI	203	JAPAN
Vizada (NOR)	204	NORWAY
Korea Telecom	208	SOUTH KOREA

8. Select an LES then press the **Enter** key
9. Select [Confirmation] then press the **Enter** key.
10. To request notification of delivery from the LES, select [ON]. If not necessary select [OFF]. Press the **Enter** key.
11. Select [Send Delay] then press the **Enter** key. To send a message after a certain delay, enter a time up to 23 hours 59 minutes. Press the **Enter** key.

12. Select [Delivery Delay] then press the **Enter** key.
Select [Immediate] or [Deferred] then press the **Enter** key.
13. Select [Code] then press the **Enter** key.
14. Select [IA5] then press the **Enter** key.
15. Put the cursor on [TRANSMIT] then press the **Enter** key to show the [Start] window.
16. Press the **Enter** key to send the message to the message queue.
17. Long-press the **Esc** key to return to the standby display.

If the message was sent successfully, "Successful Sending message" appears and the TX message is printed (if [Confirmation] is OFF).

How to cancel transmission on a message awaiting transmission

Press the **F3** and **2** keys to show the [Cancel] screen.

Cancel						
No.	Message File	Destination	LES	Priority	Send	Status
01	S11111.001	INET	Vizada 101	Normal	Sending	

Select the message to cancel then press the **Enter** key.
Press the **Enter** key again to cancel the message.

HOW TO SEND THE DISTRESS ALERT

When a life-endangering situation arises on your vessel, send the distress alert as shown below.

1. If you have time to specify the nature of distress do steps 1) to 15) below. If not, go to step 2.
 - 1) Press the **F9** key to display the [Distress Alert Setup] screen.

Distress Alert Setup	
LES ID	303 (KDDI)
Update Time	06:23 02-02-25 (YY-MM-DD)
Position	LAT 35:00N LON 135:00E
Protocol	Maritime
Nature	Undesignated
Course	187
Speed	10 kn

- 2) [LES ID] is selected; press the **Enter** key.
- 3) Select a suitable LES then press the **Enter** key.
- 4) Select [Update Time] then press the **Enter** key.
- 5) Enter the current time then press the **Enter** key.
- 6) Select [Position] then press the **Enter** key.
- 7) Enter your current position in latitude and longitude then press the **Enter** key.
- 8) Select [Nature] then press the **Enter** key.
- 9) Enter applicable nature of distress then press the **Enter** key.
- 10) Select [Course] then press the **Enter** key.
- 11) Enter your course then press the **Enter** key.
- 12) Select [Speed] then press the **Enter** key.
- 13) Enter your speed then press the **Enter** key.
- 14) Press the **Esc** key to show the [Update] window.
- 15) [Yes] is selected; press the **Enter** key to finish.
2. Open the cover of the **DISTRESS** button on the Terminal Unit IC-218 or the Distress Alert Unit/Received Call Unit IC-305.

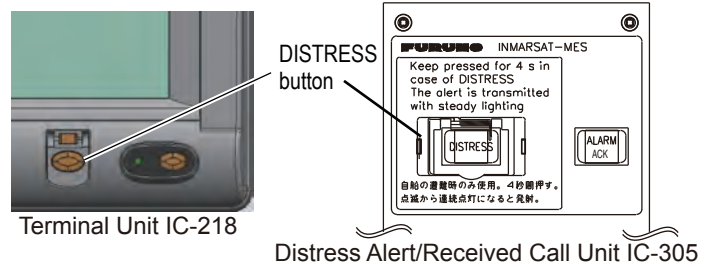

3. Press the **DISTRESS** button until (approx four seconds) the lamp in the button lights continuously. The distress alert will not be sent until the lamp in the button lights continuously and the audio alarm sounds. The message "Sending Distress Alert" appears on the screen while the distress alert is being sent.

HOW TO SEND A DATA REPORT AT REGULAR INTERVALS

1. Press the **F5** and **1** keys to show the [Data Report] menu.
2. Press the appropriate numeric key to select a data report.

Data Report	
Data Report Programming	
Status	OFF
Report Length	Position and Course/Speed
Destination	
DNID	
LES ID	
Member No.	
Activation	Regular Interval
Interval Time	00:10
Report Times	1 (---: No Limit)
Start Time1	--:--
Start Time2	--:--
Start Time3	--:--
Start Time4	--:--

3. Press the **Enter** key to open the status options window.
4. Select appropriate option then press the **Enter** key.
 - OFF:** Data report off
 - ON:** Enhanced Data Report (Data report w/confirmation)
 - ON:** Usual Data Report (Standard data report)
5. Select [Report Length] then press the **Enter** key.
6. Select appropriate option then press the **Enter** key.
 - Position only:** Own position
 - Position and Course/Speed:** Position, course and speed
 - Position and Course/Speed with SEA INF:** Position, course, speed, water temperature, tide, and depth
7. Select [DNID] then press the **Enter** key.
8. Select DNID desired then press the **Enter** key.
9. Select [LES ID] then press the **Enter** key.
10. Select LES ID desired then press the **Enter** key.
11. Select [Member No.] then press the **Enter** key.
12. Select Member No. desired then press the **Enter** key.
13. Select [Activation] then press the **Enter** key.
14. Select [Regular Interval] then press the **Enter** key.
15. Select [Interval Time] then press the **Enter** key.
16. Key in interval time then press the **Enter** key.
17. Select [Report Times] then press the **Enter** key.
18. Key in the report times, or press the **BackSpace** key to display "---" to select [No Limit] to transmit data until the Status setting is turned OFF. Press the **Enter** key.
19. Press the **Enter** key to close the window.

