

## VISION TECHNOLOGY

# MK 37 VT DIGITAL GYROCOMPASS



*The New  
Industry Standard*

### **MK 37 VT Highlights.....**

- Superior operational performance - automatic speed and latitude compensation
- Compact three unit system design - reduced cabling requirements
- Proven reliable master compass
- User friendly display/control panel includes additional heading repeater
- Simultaneous output of heading data in analog and serial formats
- Automatic transfer feature with dual system configurations
- Innovative course and rudder angle recorder option

 **Sperry**  
Marine

# MK 37 VT Digital Gyrocompass

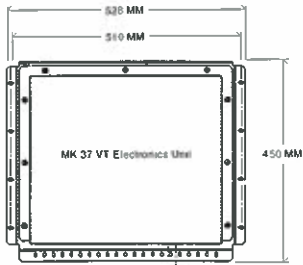

Top View

MK 37 VT Electronics Unit - 18 Kg

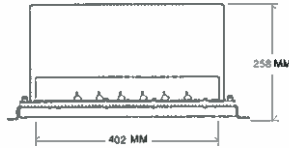

Front View

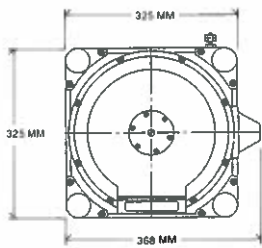

Top View

MK 37 VT Master Compass - 38 Kg

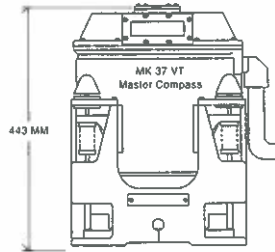

Front View

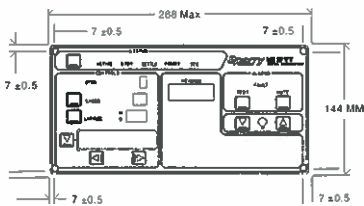

Front View

MK 37 VT Display Assembly - 5.5 Kg

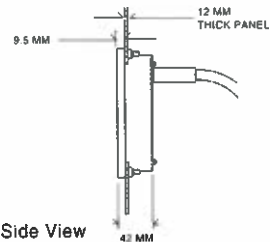

Side View

## PERFORMANCE:

Linear Mean Settle Point Error  
Scorsby Error ( $\pm 25^\circ$  roll,  $\pm 15^\circ$  pitch)  
Master Compass Angular Freedom  
Latitude Correction

## Speed Correction

Settle Time  
Temperature Range  
**INPUT INTERFACE:**  
Serial Data Inputs

$\pm 0.10^\circ$  Secant Latitude  
 $0.90^\circ$  Secant Latitude  
 $\pm 45^\circ$  in roll and pitch  
Automatic with manual latitude input or GPS input  
Automatic with manual speed input or Speed Log input  
Less than 5 hours (unaided)  
Complies with ISO 8728

One serial RS232 and one RS422 input.  
Speed — The MK 37 VT can accept NMEA 0183 "VHW" and/or "VBW" messages for speed input.  
Latitude — Latitude data is extracted from position messages. The MK 37 VT will monitor input for "GGA" and/or "GLL" sentences.

## Speed Input, Contact Closure

200 pulses per nautical mile contact closure  
Input Speeds within the range of 0 to 70 knots are considered valid.

## OUTPUT INTERFACE:

Serial Heading and Status Outputs

One RS-422 and two RS-232 serial outputs to distribute digital heading.  
All data is in NMEA 0183 format. The RS-422 line is capable of driving up to 10 loads from a single output. The RS-232 outputs can drive a single load.

## Step Channel Output

Eight Step Data outputs; 24 VDC, 6 steps per degree.

## Rate-of-Turn Output

One analog Rate of Turn output; - 50mV per degree/minute ( $\pm 4.5$  volts full scale =  $\pm 90$  degrees/min) output will drive up to 3 indicators.

## Power Failure Alarm Outputs

Power Fail relay contacts (Form C contacts) - (rated at 1 AMP @ 30 VDC and/or 300 mA @ 115 VAC)

## Compass Failure Alarm/Contacts

Compass failure alarm relay contacts (Form C contacts) - (rated at 1 Amp @ 30 VDC and/or 300 mA @ 115 VAC)

## Power Requirements

Input Voltages:  
115/230 VAC,  $\pm 10\%$ , 47-64Hz  
Mains: +24 VDC @ 8 A  
Emergency: +24 VDC @ 8 A

Contact:



**For Your Nearest Sales and Service Office Contact:**

Sperry Marine Inc.

1070 Seminole Trail

Charlottesville, VA 22901-2891, USA

Tel: (804) 974-2000 • Fax: (804) 974-2259

*Over 200 Marine Sales & Service Locations Worldwide*